

Product Instructions

Important before mounting:

Select an even, flat surface; uneven and rough surfaces diminish the hanging capacity. Do not stick to vinyl wall coverings or wall paper. Surface must be clean, dry, and free from dust and grime. Clean surface thoroughly (eg alcohol wipes). Correct preparation of surface prior to the application of Multihook™ is a key factor in ensuring maximum bond strength.

Mounting Instructions:

Step 1

Remove the protective layer from one piece of adhesive tape and attach it to the back of PART A. (fig 1) Press firmly for a few seconds.

Step 2

Repeat this process for PART B. Then attach PART A to the wall or other attachment surface and attach PART B to the object to be mounted.

Step 3

Attach PART A to PART B. Once the object is in position it can be rotated through 360 degrees. Note: The object can be removed from the wall and re-hung in the same position as many times as you wish.

Alternative hanging methods:

For additional security, a screw is recommended when fixing the Multihook™ to a surface. Refer to 'Using Screws' on our website to view the pre-drilled countersunk holes in both parts of the Multihook™ MAXI. You may also use hot glue or other industrial adhesives.

Simple to remove:

To remove the Multihook™ from a surface, hold a length of fishing line or a guitar string between your hands, place it behind the Multihook™ and gently slide it down using a side to side sawing motion.

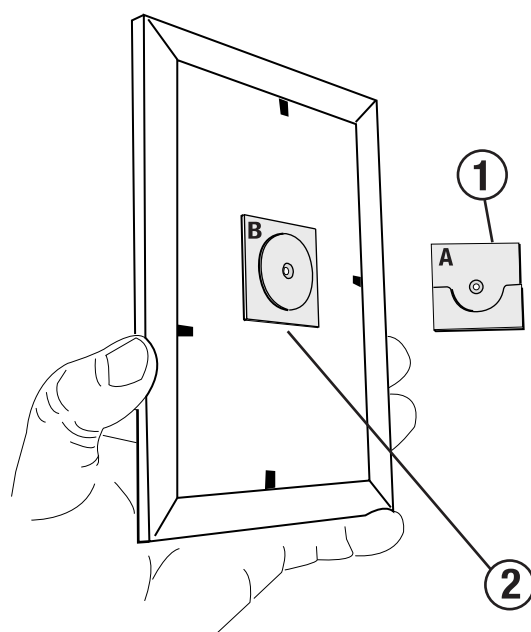

② **Important**
Mount Part B approximately in the centre of an object.

Multihook™ Systems

Head Office
PO Box 146 St Ives
New South Wales 2075
Sydney Australia
Telephone: + 61 2 9449 6601
Faxsimile: + 61 2 9449 8330
enquiries@multihook.com